

# Index For "Cooling Systems" Section

Click on page numbers to the right of the description to jump you to that specific page.

<b>A</b>	
<b>Adjustable</b>	
Electric Fan Thermostats .....	47
<b>C</b>	
<b>Clamps</b>	
Radiator Hose .....	49
<b>Coolant Additive</b> .....	42
<b>D</b>	
<b>Dual Fans</b> .....	45
<b>E</b>	
Electric Fans.....	44, 45
<b>Electric Fan</b>	
Mounting Straps .....	46
Pigtails .....	46
Relay Kits .....	47
Temp Switches .....	47
Thermostat Cover.....	47
Thermostats .....	46, 47
<b>F</b>	
<b>Fan</b>	
Mounting Straps .....	46
Relay Kits .....	47
& Shroud Combos.....	44, 45
Shrouds.....	43, 45
Spacers .....	42
Temp Switches .....	47
Thermostats .....	46, 47
<b>Fans</b>	
Electric .....	44, 45
Mechanical .....	42
Spacer.....	42
Fuel Line Clamps.....	49
<b>H</b>	
<b>Heater</b>	
Fittings.....	49
Hose Clamps .....	49
Hose Nipples .....	49
Hoses .....	48
<b>M</b>	
<b>Mechanical</b>	
Fans .....	42
Spacer.....	42
Fan Shrouds.....	43
<b>O</b>	
<b>Overflow Tanks</b> .....	41
<b>R</b>	
<b>Radiator</b>	
Caps.....	41
Clamps.....	49
Hoses .....	48
Mounting Kit.....	42
Overflow Tanks .....	41
Relief (Coolant Additive).....	42
<b>Radiators</b> .....	39
<b>Relays</b>	
Electric Fan .....	47
<b>S</b>	
<b>Shrouds</b> .....	43
<b>T</b>	
<b>Thermostat</b>	
Housing Riser.....	48
Housings.....	48
<b>Thermostats</b> .....	48
<b>Transmission</b>	
Cooler/Mounting Bracket.....	40
<b>W</b>	
<b>Water</b>	
Necks.....	48
Pump Fittings .....	49
Wetter .....	42
<b>Wire</b>	
Disconnects .....	46

### Walker Copper & Brass Radiators

**Many More Applications Available - Check our Web Site for Information**

Walker radiators are manufactured for each make & model specifically with proper brackets and mounting pads to truly bolt in. All radiators designed for 15 lb. to 18 lb. cap and include drain cock and transmission cooler. Walker Radiator cooling fins are designed for maximum efficiency with computer controlled pressed louvers in each fin crossing. The louvers location and angle in these fins is designed to create a scrubbing effect on the fin thus making the core extremely efficient. Each coolant tube is precisely 1/4" which allows for an additional number of tubes across the radiator width. Placement of tubes and fins is also computer controlled to give a uniform bond between the tubes and fins which is essential for maximum heat transfer and strength. Cobra radiators are designed for stock engines with no modifications while Z-Series radiators are designed for the all other engines. Z-Series radiators have an additional row of tubes and because of the tightness of the fins between the tubes, the fins are spread apart slightly to allow air to pass through the added core thickness. Cobra core has 17 cross fins per vertical inch, the Z-Series has 12 cross fins per vertical inch.

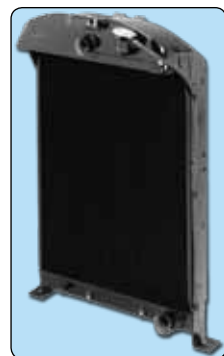

#### Cobra Series Radiators

Without A/C  
**\$679.95**

With A/C  
**\$869.95**

#### Z-Series Radiators

Without A/C  
**\$819.95**

With A/C  
**\$979.95**

Ford Car & Trk '28-'29.....	487-1 .....	C-AC487-1.....	Z-487-1.....	Z-AC487-1.....
Ford Car & Trk '33-'34.....	C-498-1 .....	C-AC498-1.....	Z-498-1.....	Z-AC498-1.....
Ford Car '39 Dlx-'40 .....	C-497-1 .....	C-AC497-1.....	Z-497-1.....	Z-AC497-1.....
Ford Car '42-'48 (V-8).....	C-493-1 .....	C-AC493-1.....	Z-493-1.....	Z-AC493-1.....
Chevy Car '46-'48 .....	C-513-1 .....	C-AC513-1.....	Z-513-1.....	Z-AC513-1.....
Chevy Car '55-'57 (V-8).....	C-567-1 .....	C-AC567-1.....	Z-567-1.....	Not Available
Camaro '67-'69.....	C-572-1 .....	Not Available.....	Z-572-1.....	Not Available
Chevy Trk '55-'59.....	C-519-1 .....	C-AC519-1.....	Z-519-1.....	Z-AC519-1.....

### Griffin Aluminum Radiators

**Many More Applications Available - Check our Web Site for Information**

The most important part of a radiators cooling capacity is its tubes. Heat dissipates from the coolant through the tube wall, then through the fins. Air passing over the fins carries away heat thereby allowing tubes and fins to absorb more heat from the coolant. The flat side of the tube is in direct contact with the fin, not the ends. Griffin radiators have only two rows but with much wider tubes. With an increased flat area of tube (and therefore fin contact) in a given thickness, the efficiency is increased dramatically. A 1" tube increases direct tube-to-fin contact and cooling capacity by roughly 25%. Therefore, a 2-row radiator with 1" tubes is equivalent to a comparable 5-row radiator with 1/2" tubes. 1" Tube radiators are for applications where cooling demands are not critical. 1-1/4" tube radiators are a higher capacity radiator for moderate to heavy cooling demands. Griffin radiators available with or without features such as transmission coolers and A/C condensers are that can be added or deleted but will reflect a difference in final radiator price.



Camaro '67-'69 - Top Lft / Btm Rt / 23" Core / 1.25" Tube / W/Trans Cooler .....	6-567AE-BAX .....	\$627.95
Nova '64-'67 - Top Lft / Btm Rt / 15.5" x 25.5" Core / 1.25" Tube W/ Cooler.....	6-566AC-BAX .....	\$627.95
Chevelle '64-'67 - Top Lft / Btm Rt / 25.5" Core / 1.25" Tube W/Trans Cooler.....	6-564AM-BAX.....	\$627.95
Chevelle '68-'70 - Top Lft / Btm Rt / 1.25" Tube / W/Trans Cooler.....	6-568AM-BAX.....	\$627.95
Chevy Car '49-'54 - Top Ctr / Btm Rt / 1.25" Tube / W/Trans Cooler .....	6-549AG-AAX.....	\$627.95
Chevy Car '55-'57 - V8 Poss. / Top Ctr / Btm Rt 1.25" Tube / W/Trans Cooler .....	6-555AH-AAX .....	\$627.95
Chevy Truck '67-'72 - Top Lft / Btm Rt / 1.25" Tube / W/Trans Cooler.....	6-567AR-BAX .....	\$627.95
Ford Car/&Trk '32 - Top Ctr / Btm Rt / 1.25" Tube / W/Trans Cooler.....	4-532BX-AAA .....	\$775.95
Galaxie '60-'63.5 - Top Rt / Btm Lft / Remote Fill / 1.25" Tube / W/Trans Cooler ...	7-560BA-FAX.....	\$627.95
Mustang '65-'66 - Top Rt / Btm Lft / 1.25" Tube / W/Trans Cooler.....	7-565BC-FAX.....	\$627.95
Mustang '67-'70 - Top Rt / Btm Lft / 24" Core / 1.25" Tube / W/Trans Cooler .....	7-568BC-FAX.....	\$627.95

### Transmission Cooler Mounting Bracket

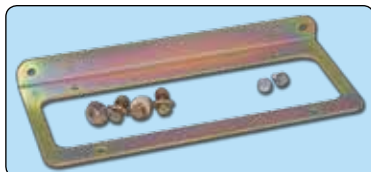
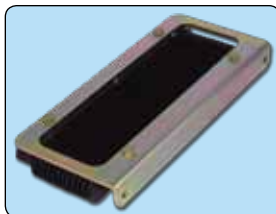

This bracket allows the cooler to be mounted 90° from any flat surface exposing both sides of the cooler to open airflow. Laser cut zinc coated steel complete with hardware.

Transmission Cooler Bracket..... SRS 70250 ..... \$29.95

### Transmission Cooler



Aluminum transmission coolers are extremely efficient, over 33% more efficient than the same size tube and fin cooler. Measures 11" long X 4-1/2" high X 1-1/2" deep and has 1/2" NPT threads. Available in polished finish or painted black.

Plain Transmission Cooler..... SRS 70260 ..... \$49.95  
 Polished Transmission Cooler ..... SRS 70265 ..... \$69.95

### Transmission Cooler & Line Kits

Universal GM or Ford Transmissions - Any Trans. With 5/16" Invert Flair

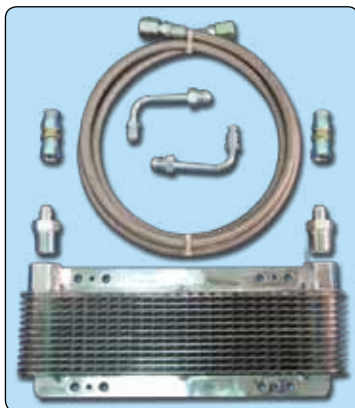

Kit with cooler features 4-1/2" high (w/brackets) X 1-1/2" deep X 11" long transmission cooler, 11' of -6 braided stainless Teflon hose with (2) -6 female fittings attached, (2) field attachable -6 female hose ends and (2) 90° transmission to -6 male adapters. You simply cut the hose to the length you need then install the supplied hose ends on each piece to make two complete lines.

Universal Transmission Cooler With Line Kit..... GOT 231106 ..... \$174.95  
 Braided Line Kit Only (No Cooler) ..... GOT 231100 ..... \$95.95

### Tube & Fin Frame Rail Transmission Coolers

2-Pass coolers feature copper tubes with internal 'turbulators' to agitate the fluid inside the tube for maximum heat transfer through to the cooling fins. Coolers also feature aluminum fin construction with plastic edge protectors and integrated end brackets to hold cooler off the frame. All coolers are 2-5/8" tall X 1-7/8" off the frame to the



outside of the cooler. Measurements below are an overall measurement, allow additional room for hose-ends and hose routing.

Barb Connections..... 16-3/4" ..... SRS 320 ..... \$35.95  
 Barb Connections..... 23-3/4" ..... SRS 324 ..... \$39.95  
 -6AN Connections ..... 17-3/4" ..... SRS 321 ..... \$33.95  
 -6AN Connections ..... 24-3/4" ..... SRS 325 ..... \$39.95

### Heat Sink Frame Mount Transmission Coolers

Aluminum two-pass Heat Sink coolers use both external and internal fins to maximize heat transfer. With a 3-1/4" total height it can be mounted in a variety of locations and with the inlet and outlet ports on the same end make plumbing easier. End cap ports are 1/4" npt thread. Measurements given are overall mounting bracket.



14-1/4" ..... SRS 260 ..... \$79.95  
 17-1/4" ..... SRS 261 ..... \$85.95  
 20-1/4" ..... SRS 262 ..... \$88.95  
 26-1/4" ..... SRS 267 ..... \$109.95

### 16 PSI Aluminum Radiator Caps

Designed to be used with overflow tanks. Notched cap matches Billet Specialties power steering reservoir cap and round caps feature knurled perimeter.

	<b>Black Anodized</b>	<b>Polished Finish</b>
Plain .....	BLT BLK75120 ...\$19.95	BLT 75120 .....\$19.95
Notched .....	BLT BLK75125 ...\$29.95	BLT 75125 .....\$24.95
Circle Pattern .....		BLT 75220 .....\$19.95
V-8 Symbol .....		BLT 75420 .....\$19.95
Bow-Tie Logo .....		BLT 75320 .....\$19.95



### Plastic Overflow Reservoir

Rectangular white plastic overflow reservoir mounts to a flat surface. Tank measures 6-1/2" wide X 6" tall (7-1/2" including tabs and hose nipple) X 4" deep. Has molded in hose nipple in bottom for 5/16" hose and comes with black plastic thread on vented cap. Plastic Overflow Reservoir ..... SRS 6031 ..... \$12.95



### Short Radiator Overflow Tank

This polished stainless steel overflow tank works well in tight spaces under the hood. Measures only 10" tall with a 3" diameter with 35 oz. capacity and 11-3/4" overall height. Short Stainless overflow tank..... SPE 911-02210..... \$51.95



### Aluminum Radiator Overflow Tanks

Unique mounting brackets are fully adjustable allowing bracket to be mounted anywhere through the entire length of tank. Thread-on knurled aluminum cap with O-ring seal. Polished to an unbelievable mirror shine.

13" (14-1/2" Overall).....	10 oz. ....	BLT 77113 .....	\$99.95
15" (16-1/2" Overall).....	13 oz. ....	BLT 77115 .....	\$99.95
17" (18-1/2" Overall).....	16 oz. ....	BLT 77117 .....	\$99.95

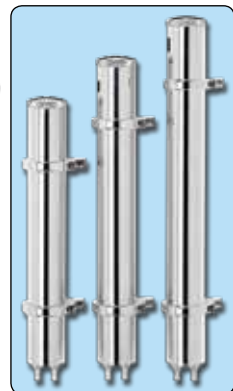

### Stainless Radiator Overflow Tanks

Polished stainless steel 2" diameter tank with polished aluminum filler neck and knurled cap with O-ring seal. Polished stainless mounting brackets with stainless hardware included.

13" (15-1/4" Overall).....	20 oz. ....	VIN B-8005-WO13 .....	\$54.95
15" (17-1/4" Overall).....	24 oz. ....	VIN B-8005-WO15 .....	\$54.95
17" (19-1/4" Overall).....	28 oz. ....	VIN B-8005-WO17 .....	\$54.95
19" (21-1/4" Overall).....	32 oz. ....	VIN B-8005-WO19 .....	\$54.95
Polished Aluminum Cap & Neck With Screws .....		VIN B-8005-RK .....	\$14.95
Stainless Mounting Hardware Kit.....		VIN B-8005-MK.....	\$5.95



### Mechanical Fans

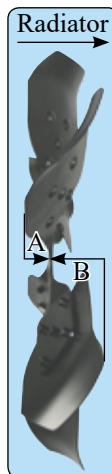

#### 5/8" Pilot Hole - Will Fit Short Or Long Pump Bolt Pattern

Fixed-blade design means no matter the rpm these fans are going to have positive air displacement. With flex-blade fans the blades flatten with rpm loosing their pitch which means they loose the ability to move air.

Diameter	Thickness	Toward Engine (A)	Toward Radiator (B)		
15"	2-1/8"	7/8"	1-1/4"	SRS 315	\$44.95
17"	2-1/8"	7/8"	1-1/4"	SRS 317	\$44.95
18"	2-1/4"	7/8"	1-3/8"	SRS 318	\$44.95
Reverse Rotation (Counter Clockwise / Serpentine Belt)					
17"	2-1/4"	7/8"	1-3/8"	SRS 417	\$46.95

### Mechanical Fan Spacers

Aluminum spacers feature 5/8" recess for water pump pilot and 5/8" stout to keep the fan centered. Spacers design is slotted where bolts go through so it will fit GM short or long water pumps. Bolts included with 5/16"-24 thread to fit most GM & Ford pumps. 3" diameter and satin finish.



1/2" Thick	MRG 2391	\$18.95
1" Thick	MRG 2392	\$17.95
1-1/2" Thick	MRG 4952	\$18.95
2" Thick	MRG 2393	\$19.95

### Radiator Relief Coolant System Improver



Radiator Relief helps control high operating temperatures. May reduce coolant system temperatures by as much as 30° F. Simply remove one quart from your coolant system and replace with 32oz. bottle of Radiator Relief. One bottle is adequate for cooling systems up to 3-1/2 gallons. Compatible with all types of antifreeze and block/radiator sealers.

Radiator Relief (32 oz. Bottle)	DEI 40104	\$16.95
---------------------------------	-----------	---------

### Red Line Water Wetter Cooling System Treatment



This unique additive reduces coolant temperatures by as much as 20 degrees while proving corrosion and rust protection for modern aluminum and cast iron cooling systems. Water Wetter can be used in plain water to provide much better heat transfer properties and protection than glycol-based antifreeze, or added to new or used antifreeze to fortify inhibitors and reduce foaming.

Water Wetter (12oz Bottle)	RED 80204	\$11.95
----------------------------	-----------	---------

### 28"-48" Ford Radiator Mounting Kits

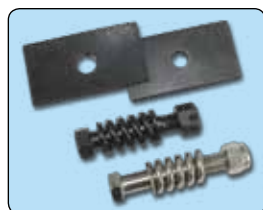

Original style kit features black oxide bolts with castle nuts and cotter pins. Stainless kit features all stainless pieces with ny-loc nuts. 2 bolts, springs, pads & nuts.		
Original Style	VIN B-8130-S	\$5.50
Stainless Kit	VIN B-8130-SS	\$14.95

## Mechanical Fan Shrouds

**U-Cut Fan Opening**  
**Other Than Applications Listed Can Be Universal**  
 By using a shroud you get the most from your fan because the shroud forces all the air the fan pulls to be pulled through the radiator core. These high strength polyethylene shrouds are manufactured specifically to fit the core dimensions. Shrouds are shipped in "blank" form for you to cut the fan hole.

### Ford

'30-'31.....	WAL WS-55A.....	\$75.95
'32.....	WAL WS-55A <sup>1</sup> .....	\$75.95
'33-'35.....	WAL WS-55A <sup>1</sup> .....	\$75.95
'37-'39 Standard.....	WAL WS-60.....	\$75.95
'39-'41.....	WAL WS-40.....	\$75.95
'42-'57.....	WAL WS-70.....	\$75.95

### Chevrolet

'32-'41.....	WAL WS-55A <sup>1</sup> .....	\$75.95
'36 Pickup & Panel.....	WAL WS-55A <sup>1</sup> .....	\$75.95
'37-'40 Pickup & Panel....	WAL WS-55A.....	\$75.95
'41-'46 Pickup & Panel....	WAL WS-55A.....	\$75.95
'47-'53 Pickup & Panel.....	WAL WS-70.....	\$75.95
'46-'48.....	WAL WS-70.....	\$75.95

### Pontiac

'31-'32.....	WAL WS-55A.....	\$75.95
'33.....	WAL WS-55A <sup>1</sup> .....	\$75.95
'36-'38.....	WAL WS-55A.....	\$75.95
'39-'40.....	WAL WS-55A.....	\$75.95

### Buick

'36-'38.....	WAL WS-55A.....	\$75.95
'40.....	WAL WS-55A <sup>1</sup> .....	\$75.95
'42-'49.....	WAL WS-55A <sup>1</sup> .....	\$75.95

### Oldsmobile

'36.....	WAL WS-55A <sup>1</sup> .....	\$75.95
'37.....	WAL WS-55A.....	\$75.95
'39-'40.....	WAL WS-55A.....	\$75.95

### Plymouth

'32 P.A. & P.B. ....	WAL WS-55A.....	\$75.95
'36.....	WAL WS-55A <sup>1</sup> .....	\$75.95
'37 Truck.....	WAL WS-55A <sup>1</sup> .....	\$75.95
'41-'48.....	WAL WS-70.....	\$75.95

### Dodge

'34.....	WAL WS-55A.....	\$75.95
'35-'36.....	WAL WS-55A <sup>1</sup> .....	\$75.95
'36-'38 Truck.....	WAL WS-55A <sup>1</sup> .....	\$75.95

<sup>1</sup> Trim To Fit WS-55A Shroud To Fit This Application.



### WS-40

**Thickness:** 2" (Straight / Not Tapered)  
**Overall Size:** 20" H (24" Arc) x 21-1/4" W  
**Raised Area:** 19-1/2" H (23-1/2" Arc) x 20" W  
**Flanges:** 1/2" (Sides Only)



### WS-55A

**Thickness:** 2-3/8" (Top) x 1-3/4" (Btm) (Tapered)  
**Overall Size:** 22" H x 18" W (20-1/2" Bulge)  
**Raised Area:** 21-1/2" H x 16" W (18-1/2" Bulge)  
**Flanges:** 7/8" (Sides) x 3/8" (Top) x 1/8" (Btm)  
**Notes:** Fan Bulge Center 9-3/4" From Bottom



### WS-60

**Thickness:** 2-3/8" (Top) x 1-3/4" (Btm) (Tapered)  
**Overall Size:** 23-1/4" H x 16" W (19-1/2" Bulge)  
**Raised Area:** 22-1/4" H x 15" W (18-1/2" Bulge)  
**Flanges:** 3/8" (Sides) x 1/8" (Top) x 1/2" (Btm)  
**Notes:** Fan Bulge Center 10-1/2" From Bottom

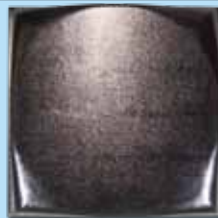

### WS-70

**Thickness:** 2-1/2" (Top) x 1-3/4" (Btm) (Tapered)  
**Overall Size:** 19-1/2" H x 20" W  
**Raised Area:** 19" H x 19" W  
**Flanges:** 3/8" (Sides) x 1/8" (Top) x 1/8" (Btm)

**CCI-1720**  
  
**\$353.95**  
 Shroud Overall.....20" X 19"  
 Raised Area ..... 17-1/2" X 17"

**CCI-1740**  
  
**\$353.95**  
 Shroud Overall .24-3/8" X 19"  
 Raised Area ..... 20-1/4" X 17-1/4"

**CCI-1750**  
  
**\$369.95**  
 Shroud Overall .18-1/2" X 22"  
 Raised Area ..... 16-1/4" X 21-1/4"

**CCI-1770**  
  
**\$353.95**  
 Shroud Overall .20-1/2" X 20-1/2"  
 Raised Area ..... 18-1/2" X 18-1/2"

**CCI-1780**  
  
**\$353.95**  
 Shroud Overall.....26" X 19"  
 Raised Area .....22" X 17-3/8"

**CCI-1790**  
  
**\$369.95**  
 Shroud Overall.....26" X 16-1/2"  
 Raised Area .....22" X 15-1/2"



**Electric Fan & Shroud Combos**  
**Mounts Behind Radiator - 70A Relay Kit Recommended**

These high CFM electric fan and shroud combinations are a good choice if an electric fan is your primary cooling system. The fan combined with a shroud to pull air through more square inches of radiator core area than if the same size fan was used alone.

- Ford**
- Car & Truck '17-'27 ....CCI-1720
  - Car & Truck '28-'29 ....CCI-1720
  - Car & Truck '30-'31 .. CCI-1750<sup>1</sup>
  - Car & Truck '32..... CCI-1750<sup>1</sup>
  - Car & Truck '33-'34.. CCI-1750<sup>1</sup>
  - Car '35-'36 ..... CCI-1750<sup>1</sup>
  - Car '37-'39 Std. ....CCI-1730
  - Car '39 Dlx-'41 .....CCI-1740
  - Car '42-'56 .....CCI-1770
  - Car '63-'75 .....CCI-1780
  - Mustang '64-'69 .....CCI-1720
  - T-Bird '55-'57.....CCI-1770
  - T-Bird '61-'66.....CCI-1780
  - T-Bird '67-'69.....CCI-1740
  - T-Bird '70-'79.....CCI-1780
  - Truck '35-'39.....CCI-1770
  - Truck '40-'52.....CCI-1740
  - Truck '53-'65.....CCI-1780
- Chevy**
- Car '29-'41 ..... CCI-1750<sup>1</sup>
  - Car '42-'46 .....CCI-1770
  - Car '49-'57 .....CCI-1740
  - Car '58 .....CCI-1770
  - Impala '59-'70 (15-1/2" Radiator Core Height).....CCI-1790
  - Impala '59-'70 (17" Radiator Core Height).....CCI-1780
  - Camaro '67-'69.....CCI-1740
  - Camaro '70-'79.....CCI-1780
  - Chevy-II/Nova '62-'67 CCI-1790
  - Chevelle '64-'69 (15-1/2" Core Height) .....CCI-1790
  - Chevelle '68-'77 (17" Radiator Core Height).....CCI-1780
  - Monte Carlo '70-'79 ....CCI-1780
  - Truck '29-'46..... CCI-1750<sup>1</sup>
  - Truck '47-'54.....CCI-1770
  - Truck '55-'59.....CCI-1740
  - Truck '60-'65.....CCI-1780
- Buick**
- Car '31-'49 ..... CCI-1750<sup>1</sup>
  - Car '50-'57 .....CCI-1740
  - Car '58-'70 .....CCI-1780
- Cadillac**
- Car '36-'56 .....CCI-1770
  - Car '57-'70 .....CCI-1780
- Oldsmobile**
- Car '35-'37 ..... CCI-1750<sup>1</sup>
  - Car '38 .....CCI-1770
  - Car '39-'40 .....CCI-1750
  - Car '41-'48 .....CCI-1770
  - Car '50-'53 .....CCI-1740
  - Car '56-'76 .....CCI-1780
- Pontiac**
- Car '31-'40 ..... CCI-1750<sup>1</sup>
  - Car '41-'48 .....CCI-1770
  - Car '49-'54 .....CCI-1740
  - Car '64-'79 .....CCI-1780
  - Firebird '67-'69 .....CCI-1740
  - Firebird '70-'79 .....CCI-1780
  - GTO '64-'67 (15-1/2" Radiator Core Height).....CCI-1790
  - GTO '64-'67 (17" Radiator Core Height) .....CCI-1780
- Dodge**
- Car '33 ..... CCI-1750<sup>1</sup>
  - Car '36 ..... CCI-1750<sup>1</sup>
  - Car '41-'52 .....CCI-1770
  - Car '60-'72 .....CCI-1780
  - Truck '50 .....CCI-1770
  - Truck '54-'57.....CCI-1740

<sup>1</sup> Can Use CCI-1730 For Tight Applications. See Next Page.

### Close Fit Application Cooling Components Fan

Shroud Overall . 18-1/2" X 20-1/4"  
 Raised Area .....16" X 19-1/4"

Universal design of this kit features the fan mounted all the way to the top of the shroud and leaned in at the bottom to take up the least thickness possible for installations where the water pump pulley is very close to the radiator. 70 Amp relay recommended.

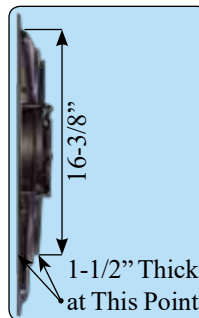

Close Fit Cooling Components Fan ..... CCI-1730 .....\$324.95

### Cooling Components Dual Fan Combos

**Requires Two 70-Amp Relays**

Two high CFM 12" electric fans mounted to a high-impact ABS shroud for the ultimate cooling combo. Two slightly different width models designed for the later car market with shorter but wider radiator dimensions. Shrouds attach to the radiator by



**CCI-1226**

Shroud Overall .....28" X 18"  
 Raised Area ..... 26-1/2" X 16"

**CCI-1228**

Shroud Overall .....30" X 18"  
 Raised Area ..... 27-1/2" X 16"

drilling through the flat areas molded as one piece of the heavy shroud material. These are extremely heavy duty fans and draw considerable current when both fans are in operation. Consideration should be made to your charging system to make sure you have enough charging capacity from your alternator. Either Dual Fan Combo ..... \$499.95

### Dual 11" Fan & Shroud Combo

**70 Amp Relay Kit Required - Must Be Used Behind Radiator - Can Be Used Vertically Or Horizontally**

These dual high performance 11" fans are encased in a strong, all glass filled nylon construction one-piece shroud to get maximum efficiency by pulling air through as much radiator core as possible. Shroud features "ram-air" doors to allow air to flow through at higher vehicle speeds. When the fans are on these doors are pulled closed forcing the air to be pulled through the radiator. Available with mounting flanges along either the long or short sides of shroud. Shown measurements are without mounting flange, add 1-1/4" for each flange or 2-1/2" total for shrouds with mounting flanges.

Without Mounting Flanges (Shown).....MPF MM22K ..... \$269.95  
 Long Side Mounting Flanges.....MPF MM22KT ..... \$269.95  
 Short Side Mounting Flanges.....MPF MM22KS ..... \$269.95

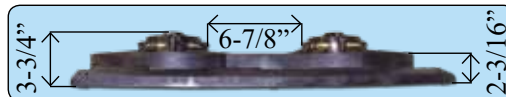
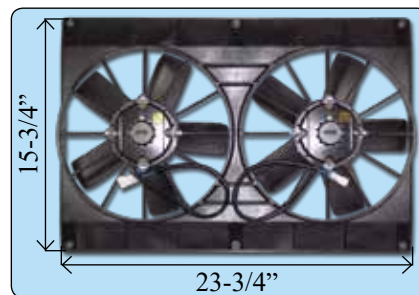

### Performance S-Blade Electric Fans

True performance fans from a real fan manufacturer to not just aftermarket but OEM's too. Curved "S-Blade" design for quiet operation and reversible for mounting in front or behind radiator. Glass filled nylon construction for the highest impact resistant fan on the market.

Dim "A"	Dim "B"	CFM	Part Number	Price
10"	1"	950	MPF M103K	\$102.95
12"	1"	1565	MPF M122K	\$128.95
14"	1"	2135	MPF M142K	\$132.95
16"	1"	2170	MPF M162K	\$140.95

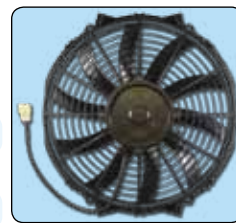



### Aluminum Electric Fan Mounting Brackets

Designed to Fit Maradyne 14" & 16" Fans – Can be Universal

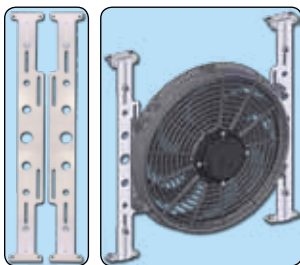

Aluminum fan mounting brackets features telescopic mounting ends to accommodate radiator widths (or heights if mounting up and down) from 15" to 22-3/8". Instructions and all hardware including mounting screws to radiator included.

Aluminum Electric Fan Mounting Kit .....MPF MFA105 ..... \$44.95

### Electric Fan Mounting Straps Only

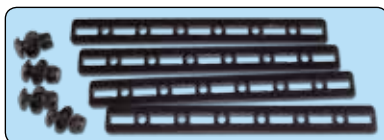

All Maradyne 10", 12", 14" & 16" auxiliary fans listed on the previous page come with the clip-on 90° elbow adapters. These metal straps simply mount to plastic clips already provided. Includes (4) 7-1/4"

long steel straps and hardware.

Strap Fan Mounting Kit .....MPF MFA104 ..... \$18.95

### Zip-Tie Fan Mounting Kit



Ties slide between the fins of the radiator or condenser and through the mounting ears on the fan and comes with foam pads to protect the fins. We prefer the above mounting straps and do not recommend these be your first solution to fan mounting.

Zip-Tie Fan Mounting Kit .....MPF M0912T ..... \$6.95

### Electric Fan Pigtail Fits Maradyne Fans



The Maradyne 10", 12", 14" and 16" auxiliary fans come with this pigtail kit but the dual 11" fans do not. Don't ask me, I don't know... Simple male plug clips and locks into the female plug off the fan motor wiring.

Fan Pigtail .....MPF MFA113 ..... \$4.95

### Quick Connectors For Use With 18-14 Gauge Wire

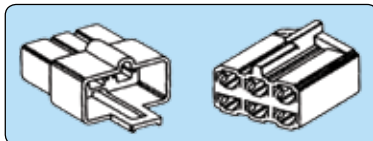

Plastic connector housings lock together and are indexed so that they fit together only one way. Complete with brass terminals that lock into the housings.

1 Wire.....	AAW QCK-1 .....	\$6.00	4 Wire.....	AAW QCK-4.....	\$9.00
2 Wire.....	AAW QCK-2.....	\$7.00	6 Wire.....	AAW QCK-6.....	\$10.00
3 Wire.....	AAW QCK-3.....	\$8.00	8 Wire.....	AAW QCK-8.....	\$11.00

### Programmable Electric Fan Controller Triggers From Your Existing Water Temp Gauge Sender *Dakota Digital*



Controller works with most existing electronic water temp gauges operating from the single-wire temperature sending unit already installed or a dedicated sending unit can be used. Features fully programmable "fan on" and "fan off" temperatures to suit any application or preference and a full digital LED readout for displaying temperature readings and maintaining simple installation. Recommended mounting inside the cab of the vehicle or alternate dry environment. The use of a second relay (not included) will be required for dual fan or two speed fan operation. One 70 amp relay included.

Programmable Electric Fan Controller ..... DAK PAC-2750 .... \$119.95

### Adjustable Electric Fan Thermostat

**Must Be Used With Electric Fan Relay Kit**

Thermostatic switch features probe with 1/4" npt fitting to install in lower radiator tank when drain cock is removed. Adjustable knob allows you to dial when the fan comes on. Allows temperature settings between 180° and 240°. Can be used in conjunction with trinary safety switch.

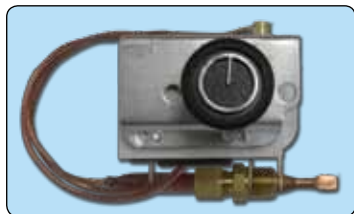

Adjustable Electric Fan Thermostat..... VAA 24675-VUT.....\$35.95

### Electric Fan Adjustable Thermostat Cover

**Fits Above Vintage Air Adjustable Thermostats Only**



Satin finish aluminum cover slips over adjustable thermostat. Insulated wire end terminals included.

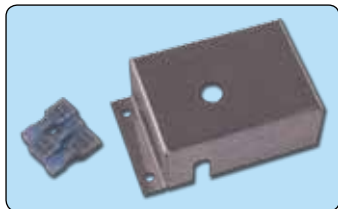

Electric Fan Thermostat Cover ..... VIN CL-8658-W .....\$9.95

### Electric Fan Temperature Switches

**Used For Triggering Relay Systems – Vintage Air Relay Harness Recommended**

These are simply switches that turn on and off at the temp ranges shown. These switches have only one 1/4" spade connector so they will connect the wire attached to it to ground when above it is above its temp setting. The wiring harnesses listed right include wiring instructions for this "ground side" switching. Both switches have 3/8" npt threads.



190 Degree On / 170 Degree Off ..... MPF MFA108.....\$19.95

200 Degree On / 180 Degree Off ..... MPF MFA109.....\$19.95

### Electric Fan Relay & Wiring Kits

**Relay Kits Only - Requires Switch To Activate Relay**

A relay is the 'middle man' between the switch and the electric fan. The switch, be it adjustable thermostatic or toggle, simply turns on and off the relay. The relay is what handles the high amp load of delivering the electricity to the fan motor. By using a relay your switch will last longer and the system is much safer.



40 Amp Relay Kit (Most Single Fan Set-Ups) ..... AAW 500479 .....\$21.95

70 Amp Relay Kit (Most Dual or H.D. Fan Set-Ups).... VAA 23102-VUW.....\$39.95

### Electric Fan Wiring Systems

All Ron Francis Wire Works systems include 30 amp fuse and high quality relays to carry the high amperage demands of todays electric fans.

**Temperature Control** - Ron Francis offers kits with 3/8" NPT sender to sense water temperature and turn the electric fan on and off automatically.

**A/C Request** - Kits with A/C request will (in addition to the temp sensor) turn the electric fan on when the A/C compressor is engaged.



Temperature Switch Range	A/C Request		
175 Degree On / 160 Degree Off .....	Yes .....	RFW AR-23 .....	\$86.95
175 Degree On / 160 Degree Off .....	No .....	RFW AR-29 .....	\$70.95
Replacement 175 Degree On / 160 Degree Off Temp Switch .....		RFW AR-33 .....	\$44.95
200 Degree On / 185 Degree Off .....	Yes .....	RFW AR-24 .....	\$86.95
200 Degree On / 185 Degree Off .....	No .....	RFW AR-30 .....	\$70.95
Replacement 200 Degree On / 185 Degree Off Temp Switch .....		RFW AR-34 .....	\$44.95

Order Toll Free: 1-800-495-3904  
 Tech. & Info. Line: 1-972-495-1557



Web: www.SachseRodShop.com  
 Email: sales@SachseRodShop.com

### Billet Aluminum Thermostat Housings



*Billet Specialties* thermostat housings are precision machined from 6061-T6 billet aluminum and polished to a mirror finish. All housings feature O-ring seal and come complete with stainless hardware. Angled housings swivel for proper hose angle. SB Ford housing measures 2-7/8" tall from O-ring to top of housing body.



#### Chevrolet Small and Big Block

Straight Up.....	BLT 90120.....	\$34.95
0 Degree.....	BLT 90220*.....	\$74.95
15 Degree.....	BLT 90320*.....	\$74.95
45 Degree.....	BLT 90420*.....	\$74.95



**Ford Small Block (289-351W) - 0 Degree** ..... BLT 90620..... \$94.95

#### Ford Big Block (429 - 460)

0-Degree .....	BLT 90720.....	\$99.95
15 Degree.....	BLT 90725.....	\$99.95

**Ford FE Engine - 0-Degree** ..... BLT 90730..... \$99.95

**Chrysler Small / Big Block & Hemi to '78 - Straight Up** ..... BLT 90820..... \$44.95

\* Available in black anodized finish for \$5.00 additional.

### Chevy Thermostat Housing Riser

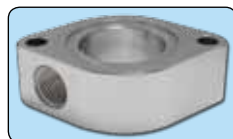

Aluminum riser has 1/2" npt threaded port for installation of heater hose nipple, fan switch, temp gauge sender or whatever. 1-1/4" tall and is gasket seal. **Note:** Thermostat must be positioned above this riser in recess shown (between riser and thermostat housing) for proper hot water flow to the heater core.

Thermostat Housing Riser ..... VAA 706001-VCQ..... \$46.95

### High-Flow Thermostats - GM / Ford Size - Mopar Size Available



If you are running a high flow water pump you should use one of these thermostats to get the maximum volume from your pump.

160 Degree.....	MRG 4363 .....	\$17.95
180 Degree.....	MRG 4364 .....	\$17.95



### Small Block Chevy Radiator Hoses

We have found a handful pre-molded hoses that might make your radiator hookup easier if your lucky. Lower hose is 1-3/4" and fits many if not most lower applications to turn off the water pump to the radiator. Upper hoses are 1-1/2".

Lower Radiator Hose.....	SRS 202 .....	\$17.95
2-Bend Upper Radiator Hose.....	SRS 203 .....	\$17.95
45° Bend Upper Radiator Hose .....	SRS 221 .....	\$17.95
90° Bend Upper Radiator Hose .....	SRS 217 .....	\$17.95



### Universal Pre-Formed 90 Heater Hoses

Quality rubber heater hoses are 36" long with a tight pre-formed 90° bend on one end approximately 4" long.



	End "A"	End "B"		
5/8" Hose .....	5/8"	5/8"	SRS 284 .....	\$19.95
3/4" Hose .....	3/4"	3/4"	SRS 279 .....	\$22.95
5/8" & 3/4" .....	5/8"	3/4"	SRS 297 .....	\$24.95

### Gates PowerGrip SB Clamps

**For Cooling System Use Only – Not For Fuel Systems**

Gates PowerGrip SB clamps are made of a heat-sensitive thermoplastic material that shrinks to tighten. Clamps maintain a dynamic tension so it never needs retightening. Maintenance-free automatically tightens when the engine comes to temperature. Each

Nominal Hose I.D.	Fits Hose O.D.	Number	
1/2"	13/16" to 15/16"	SRS SB22	\$3.25
5/8"	15/16" to 1-1/16"	SRS SB25	\$3.75
3/4"	1-1/16" to 1-3/16"	SRS SB29	\$4.00
1-1/4"	1-1/2" to 1-3/4"	SRS SB41	\$5.25
1-1/2"	1-3/4" to 2"	SRS SB48	\$5.50
1-3/4"	2" to 2-1/4"	SRS SB54	\$5.75
2"	2-1/4" to 2-1/2"	SRS SB60	\$6.00



### Polished Billet Hose Ends

Polished hose ends are an alternative to unsightly hose clamps and loud anodized colors. Precision machined from 6061-T6 aluminum, polished to a mirror finish, includes hose clamp. Each.



Fuel (3/8")	Heater (5/8")	Heater (3/4")	Radiator (Rubber Hose)
Rubber..... 67225 ... \$11.95	Rubber..... 67425 ... \$13.95	Rubber..... 67625 ... \$13.95	1-1/2" ..... 67825 ... \$21.95
Braided.... 67325 ... \$11.95	Braided.... 67525 ... \$13.95	Braided.... 67725 ... \$13.95	1-3/4" ..... 67925 ... \$21.95

### Stainless Heater Hose Fittings

The best quality 304 stainless fittings you can buy period! Made in the U.S.A.

**Short (1-3/4") Straight Heater Hose Nipples – Common intake manifold installations**

Thread	Hose	Hex or 12 Pt.	Polished	Satin
3/8" npt.....	5/8".....	Hex.....	PSS 1040-P..... \$17.95	PSS 1040..... \$12.95
3/8" npt.....	5/8".....	12 Pt.....	PSS 1039-P..... \$19.50	PSS 1039..... \$14.50
1/2" npt.....	5/8".....	Hex.....	PSS 1001-P..... \$18.75	PSS 1001..... \$13.75
1/2" npt.....	5/8".....	12 Pt.....	PSS 1010-P..... \$19.95	PSS 1010..... \$14.95
1/2" npt.....	3/4".....	Hex.....	PSS 1003-P..... \$18.75	PSS 1003..... \$13.75
1/2" npt.....	3/4".....	12 Pt.....	PSS 1012-P..... \$19.95	PSS 1012..... \$14.95



**Long (2-7/8") Straight Heater Hose Nipples – Usually installed in Chevy short pump because of how the pump is cast, it requires the longer fitting so the wrenching portion of the fitting is accessible.**

Thread	Hose	Hex or 12 Pt.	Polished	Satin
1/2" npt.....	5/8".....	Hex.....	PSS 1002-P..... \$21.50	PSS 1002..... \$16.50
1/2" npt.....	5/8".....	12 Pt.....	PSS 1011-P..... \$22.95	PSS 1011..... \$17.95
1/2" npt.....	3/4".....	Hex.....	PSS 1004-P..... \$20.95	PSS 1004..... \$15.95
1/2" npt.....	3/4".....	12 Pt.....	PSS 1013-P..... \$21.95	PSS 1013..... \$16.95



**Angled Heater Hose Nipples – Common intake manifold installations. Some of these angled fittings may be available in taller profiles. Most everything listed here will be approximately 1-5/16" to 1-3/8" tall from bottom of thread to center of hose barb.**

Thread	Hose	Angle	Polished	Satin
3/8" npt.....	5/8".....	90°.....	PSS 1047-P*... \$34.75	PSS 1047*..... \$27.75
1/2" npt.....	5/8".....	45°.....	PSS 1041-P..... \$34.75	PSS 1041..... \$27.75
1/2" npt.....	5/8".....	90°.....	PSS 1037-P*... \$34.75	PSS 1037*..... \$27.75
1/2" npt.....	3/4".....	90°.....	PSS 1049-P*... \$34.75	PSS 1049*..... \$27.75

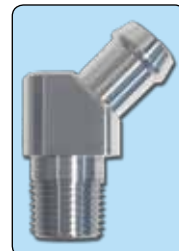

\*Available in taller profile. Call for more information.